

TRUFLO
by hindware



DURABILITY & PERFORMANCE *behind* LUXURIOUS BATH SPACES

Multilayer Composite Pipes & Fittings



A Patented (European)
technology for jointing system



TRU QUALITY TRU COMMITMENT

TRUFLO, part of the Somany Impresa Group, offers comprehensive range of premium quality pipes and fittings including **NSF-certified CPVC, lead free range of UPVC, SWR, PVC pipes and fittings, Column pipes for borewell application** and other allied products. **TRUFLO** reaffirms the commitment to quality of Hindware, the flagship brand of Somany Impresa Group, that has been built over six decades. It further strengthens Hindware's pursuit to provide complete bathroom solutions by complementing its exquisite range of sanitaryware.

TRUFLO now introduces in India, world-class, **SharkBite Multilayer Composite Piping System**. A premium range of pipes and fittings made to last long and provide superior performance. An ideal choice for truly premium plumbing. **SharkBite** Composite pipes and fittings are a product of Reliance Worldwide Corporation (RWC). **TRUFLO** is the exclusive partner for India to provide **SharkBite** range of plumbing solutions.

About RWC

Reliance Worldwide Corporation is a leader of the plumbing and heating accessories market in Europe, North America & Australia, and produces more than 78 million units a year. RWC's **SharkBite** continues to develop a distinctive brand in the field of plumbing and heating solutions.



PIPE CROSS SECTION

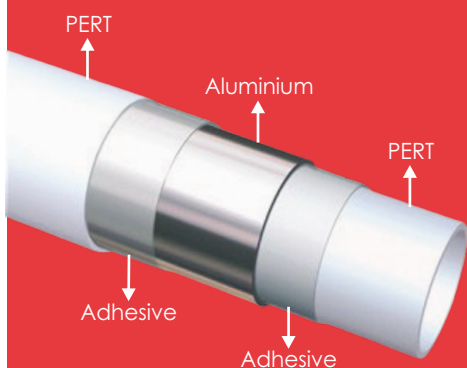

TRUFLO SharkBite Multilayer Composite Piping System

A light-weight, durable yet flexible plumbing system which is ideal for premium plumbing in all concealed applications for hot water, drinking water and chilled water. They are manufactured in Europe and comply with the following international standards:

- **ISO 21003** - Multilayer piping systems for hot and cold water installations inside buildings.
- **EN 485-2** - European standard that specifies the mechanical properties of wrought aluminium and wrought aluminium alloy sheet, strip and plate for general engineering applications.

TRUFLO SharkBite pipe is composed of five layers, **PERT / ADHESIVE / ALUMINIUM / ADHESIVE / PERT**. Polyethylene (PERT type II) a temperature resistant polymer along with butt welded aluminium "head to head".

The performance of multilayer pipes is significantly impacted by the type of aluminium alloy, thickness of the aluminium, the position of the aluminium layer, the technology used in forming and welding the aluminium, the adhesion of the PERT to the aluminium. **TRUFLO SharkBite** assures the best quality & process integration to attain this.

Material Specification

- Polyethylene raised temperature resistance (PE-RT) Dowlex 2388 Type II
- Aluminium 8006 O - 8011 O



The multiple layers are joined together with an adhesive. The Multilayer pipes acquire and combine properties of plastic along with the special aluminium layer offering a combined strength of both. Thus these pipes are:

- Have high concentricity ensuring the pipe can be bent with full warranty within the bending limits.
- They can withstand temperature ranging from -20° C to +95° C at 10 bar pressure (maximum).
- High thermo-mechanical properties assure a service life of at least 50 years. International Standards require producers of Multilayer pipe systems to perform tests that can verify and guarantee the durability of the product as per ISO 21003.
- High flexibility and ease of bending making it convenient to change direction in tight spaces compared to PVC, PP, copper or steel pipes, without the need for elbows. Further reduces probability of potential leak points and pressure losses generated by connections.
- Since the pipes are butt-welded with an Aluminum layer, they are 100% impermeable to oxygen and are thereby making it corrosion resistant.

TRUFLO SharkBite Push to Connect Fittings

The Innovative, patented fittings are manufactured using Polyphenylsulfone (PPSU), a high performance techno polymer. The fittings have a conical sealing gasket made from EPDM Peroxide-70, which guarantees a tight fixation within the internal part of the pipe. These fittings are corrosion resistant and impervious to lime scale. These also have excellent resistance to hydrolysis and chemicals, even under long-term exposure to high temperatures.

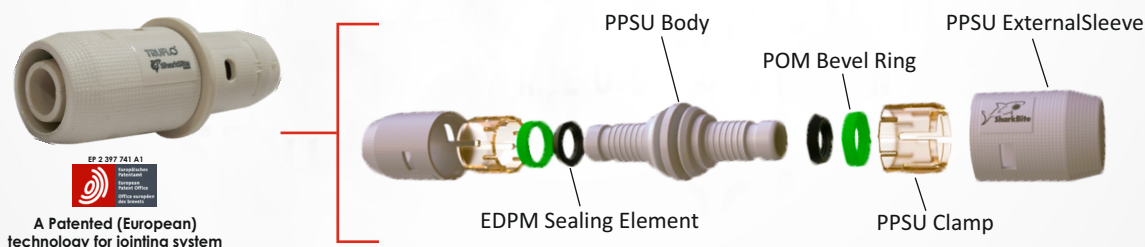

The **TRUFLO SharkBite** Push to Connect Fittings reduce the installation time, thanks to the innovative push-fit technology. These fittings are ideal for concealed plumbing even in thin partition walls. They are compatible with PEXa, PERT and MULTILAYER Aluminum pipes of 16 mm, 20 mm, 25 mm & 32 mm diameter.

THE AMAZING BENDING RADIUS

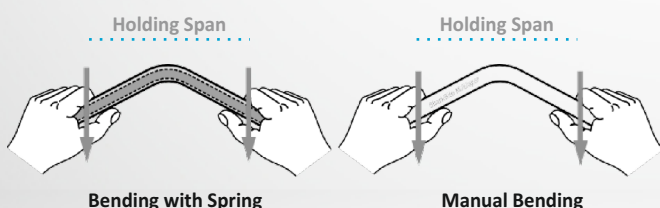

| Pipe Size (in mm) | Holding Span | With Spring R=4xØ | Manual R=5xØ |
|----------------------|-----------------|----------------------|-----------------|
| Ø 16x2.0 | 49mm | 64mm | 80mm |
| Ø 20x2.0 | 80mm | 80mm | 100mm |
| Ø 25x2.5 | 90mm | 90mm | 120mm |
| Ø 32x3.0 | 120mm | 120mm | 160mm |

IDEAL FOR

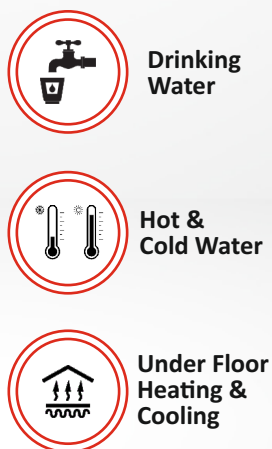

AENOR CERTIFIED



EASY 3 STEP INSTALLATION



CUT



BEVEL & CALIBRATE

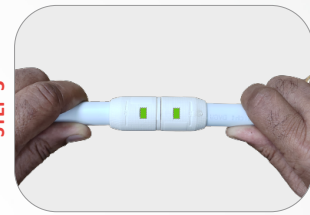

PUSH & CONFIRM WINDOW TURNS GREEN ASSURING A PERFECT JOINT

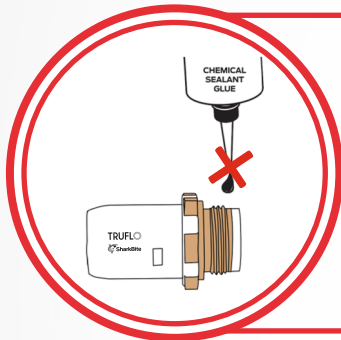

CAUTION

TRUFLO SharkBite fittings (PPSU and PPSU with metal insert) should be fitted with thread, PTFE tape, Silicone Tape or hemp / tow. Anaerobic sealants used for metal threads cause stress cracks or breakage when in contact with thermoplastic materials. Regardless of whether the threads of the fittings are metallic, indirect or accidental contact with PPSU plastic parts can cause breakage or cracks.

PTFE TAPE THICKNESSES SHOULD MEET THE FOLLOWING REQUIREMENTS:

- 0.075mm to 0.100mm tape for threads of ½"
- 0.100mm to 0.200mm tape for threads of ¾" and 1"
- The tape should be 100% PTFE only according to EN 571 - 3 Frp
- Leave the first thread free to facilitate joining.
- Do not use male brass threaded fittings of >14mm brass length to fit with Truflo SharkBite female threaded brass fittings.
- Use open-end spanner according to the brass height of the brass female threaded fitting and use another spanner to fix the male threaded fitting.

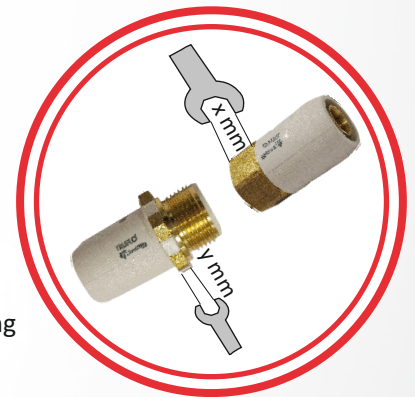

| Technical Parameters (pipe) ↓ | Sizes ⇒ | 16x2.0mm | 20x2.0mm | 25x2.5mm | 32x3.0mm |
|--|---------|------------|------------|------------|------------|
| Internal diameter (mm) | | 12 | 16 | 20 | 26 |
| Volume of liquid (ltrs./min) | | 0.133 | 0.201 | 0.314 | 0.531 |
| Max. Operating Temperature °C | | 95 | 95 | 95 | 95 |
| Min. operating temperature °C | | -20 | -20 | -20 | -20 |
| Max. Working Pressure at 95°C | | 10 bar | 10 bar | 10 bar | 10 bar |
| Coefficient of thermal conductivity | | 0.004 W/mK | 0.004 /mK | 0.004 /mK | 0.004 W/mK |
| Coefficient of thermal expansion | | 0.02 mm/mK | 0.02 mm/mK | 0.02 mm/mK | 0.02 mm/mK |
| Min. bending radius (external spring) mm | | 5 x d | 5 x d | 5 x d | 5 x d |
| Thickness of aluminium layer (mm) | | 0.20 | 0.20 | 0.25 | 0.30 |
| Oxygen diffusion (mg/ltr) | | 0 | 0 | 0 | 0 |
| Bursting pressure (bar) | | 72 | 68 | 71 | 65 |

ADVANTAGES

- Light weight, Slim Profile & Durable
- Suitable for -20° to 95°
- Quick installation & lesser joints compared to traditional plumbing systems
- High pressure & temperature resistant
- Completely oxygen-impermeable – Prevents Oxidation
- Minimum linear expansion
- Chemical resistance to building materials allows this multilayer pipe to be embedded in walls & floors without the need for any additional protection.

PRODUCT RANGE

PIPES (Coil)

MULTILAYER-PERT/AL/PERT



| ITEM CODE | SIZE (in mm) | STD PKG (Coil) |
|------------|--------------------------|----------------|
| ML01000016 | 16 x 2 (100 Metre Coil) | 1 |
| ML01000020 | 20 x 2 (100 Metre Coil) | 1 |
| ML01000025 | 25 x 2.5 (50 Metre Coil) | 1 |
| ML01000032 | 32 x 3.0 (50 Metre Coil) | 1 |

FITTINGS - (Push to connect - PPSU)

COUPLERS

Equal Coupler



| ITEM CODE | SIZE (in mm) | STD PKG |
|------------|--------------|---------|
| ML11000016 | 16 | 30 |
| ML11000020 | 20 | 20 |
| ML11000025 | 25 | 12 |
| ML11000032 | 32 | 6 |

Reducing Coupler



| ITEM CODE | SIZE (in mm) | STD PKG |
|------------|--------------|---------|
| ML12020016 | 20X16 | 20 |
| ML12025016 | 25X16 | 15 |
| ML12025020 | 25X20 | 15 |
| ML12032016 | 32X16 | 8 |
| ML12032020 | 32X20 | 8 |
| ML12032025 | 32X25 | 8 |

ELBOWS

Elbow 90°



| ITEM CODE | SIZE (in mm) | STD PKG |
|------------|--------------|---------|
| ML17000016 | 16 | 25 |
| ML17000020 | 20 | 18 |
| ML17000025 | 25 | 8 |
| ML17000032 | 32 | 5 |

Elbow with Male Thread



| ITEM CODE | SIZE | STD PKG |
|------------|----------------|---------|
| ML18000016 | 16 mm x ½ inch | 20 |
| ML18000020 | 20 mm x ½ inch | 20 |
| ML18000025 | 25 mm x ¾ inch | 10 |

Elbow with Female Thread



| ITEM CODE | SIZE | STD PKG |
|------------|----------------|---------|
| ML19000016 | 16 mm x ½ inch | 20 |
| ML19000020 | 20 mm x ½ inch | 20 |
| ML19000120 | 20 mm x ¾ inch | 10 |
| ML19000025 | 25 mm x ¾ inch | 8 |
| ML19000032 | 32 mm x 1 inch | 6 |

Wall Plate Elbow



| ITEM CODE | SIZE | STD PKG |
|------------|----------------|---------|
| ML20000016 | 16 mm x ½ inch | 15 |
| ML20000020 | 20 mm x ½ inch | 12 |
| ML20000025 | 25 mm x ¾ inch | 10 |

TEES

Tee Connector



| ITEM CODE | SIZE (in mm) | STD PKG |
|------------|-----------------|---------|
| ML21000016 | 16 | 12 |
| ML21000020 | 20 | 8 |
| ML21000025 | 25 | 5 |
| ML21000032 | 32 | 3 |

Reducer Tee Connector



| ITEM CODE | SIZE (in mm) | STD PKG |
|------------|-----------------|---------|
| ML22162016 | 16X20X16 | 12 |
| ML22201616 | 20X16X16 | 12 |
| ML22201620 | 20X16X20 | 10 |
| ML22202016 | 20X20X16 | 10 |
| ML22251625 | 25X16X25 | 8 |
| ML22252020 | 25X20X20 | 6 |
| ML22252025 | 25X20X25 | 6 |
| ML22252520 | 25X25X20 | 6 |
| ML22322525 | 32X25X25 | 4 |

Tee with Female Thread



| ITEM CODE | SIZE | STD PKG |
|------------|----------------|---------|
| ML23000016 | 16 mm X ½ inch | 15 |
| ML23000020 | 20 mm X ½ inch | 10 |

CONNECTORS

Connector with Female Thread (Plastic Body)



| ITEM CODE | SIZE | STD PKG |
|------------|----------------|---------|
| ML13000016 | 16 mm X ½ inch | 20 |
| ML13000020 | 20 mm X ½ inch | 15 |
| ML13000120 | 20 mm X ¾ inch | 15 |
| ML13000025 | 25 mm X ¾ inch | 10 |

Connector with Male Thread (Plastic Body)



| ITEM CODE | SIZE | STD PKG |
|------------|----------------|---------|
| ML15000016 | 16 mm X ½ inch | 30 |
| ML15000020 | 20 mm X ½ inch | 25 |
| ML15000120 | 20 mm X ¾ inch | 20 |
| ML15000025 | 25 mm X ¾ inch | 15 |
| ML15000032 | 32 mm X 1 inch | 8 |

Connector with Female Thread (Brass Body)



| ITEM CODE | SIZE | STD PKG |
|------------|----------------|---------|
| ML14000016 | 16 mm X ½ inch | 20 |
| ML14000020 | 20 mm X ½ inch | 15 |

Connector with Male Thread (Brass Body)



| ITEM CODE | SIZE | STD PKG |
|------------|----------------|---------|
| ML16000016 | 16 mm X ½ inch | 30 |
| ML16000020 | 20 mm X ½ inch | 25 |

OTHERS

Ball Valve



| ITEM CODE | SIZE (in mm) | STD PKG |
|------------|-----------------|---------|
| ML24000016 | 16 | 6 |
| ML24000020 | 20 | 5 |
| ML24000025 | 25 | 4 |
| ML24000032 | 32 | 3 |

End Cap



| ITEM CODE | SIZE (in mm) | STD PKG |
|------------|-----------------|---------|
| ML25000016 | 16 | 10 |
| ML25000020 | 20 | 5 |
| ML25000025 | 25 | 5 |

Calibrator



| ITEM CODE | SIZE (in mm) | STD PKG |
|------------|-----------------|---------|
| ML162025CA | 16-20-25 | 1 |
| ML000032CA | 32 | 1 |

TRUFLO range of products are manufactured at a facility that is:

ISO 9001 : 2015 certified

GreenCo Platinum Rated
for Sustainable Manufacturing



&

Green Platinum Rated
Factory Building



TRUFLO products comply with best quality standards & are certified:



NSF,
NSF/ANSI 14
for CPVC Pipes & Fittings



CIPET
(Central Institute of Plastics
Engineering & Technology) -
for CPVC, SWR, PVC Pipes & Fittings



CFTRI
(Central Food Technological Research Institute) -
for CPVC & UPVC Pipes & Fittings

TRUFLO®
by hindware

**COMPREHENSIVE RANGE OF LEAD FREE
PIPES, FITTINGS & ALLIED PRODUCTS**



Hindware Limited (Pipes Division)

"The Platina", A - 501, Gachibowli Miyapur Road, Gachibowli, Hyderabad - 500 032, Telangana.
Email: truflopipes@hindware.co.in | Website: www.truflopipes.com

Call (Toll Free): 1800-572-6655

10/04/2023